

# Flat 2-2, 296 Todd Street, Dennistoun, Glasgow G31 3SE.

Approximate Gross Internal Area

696 sq ft - 65 sq m

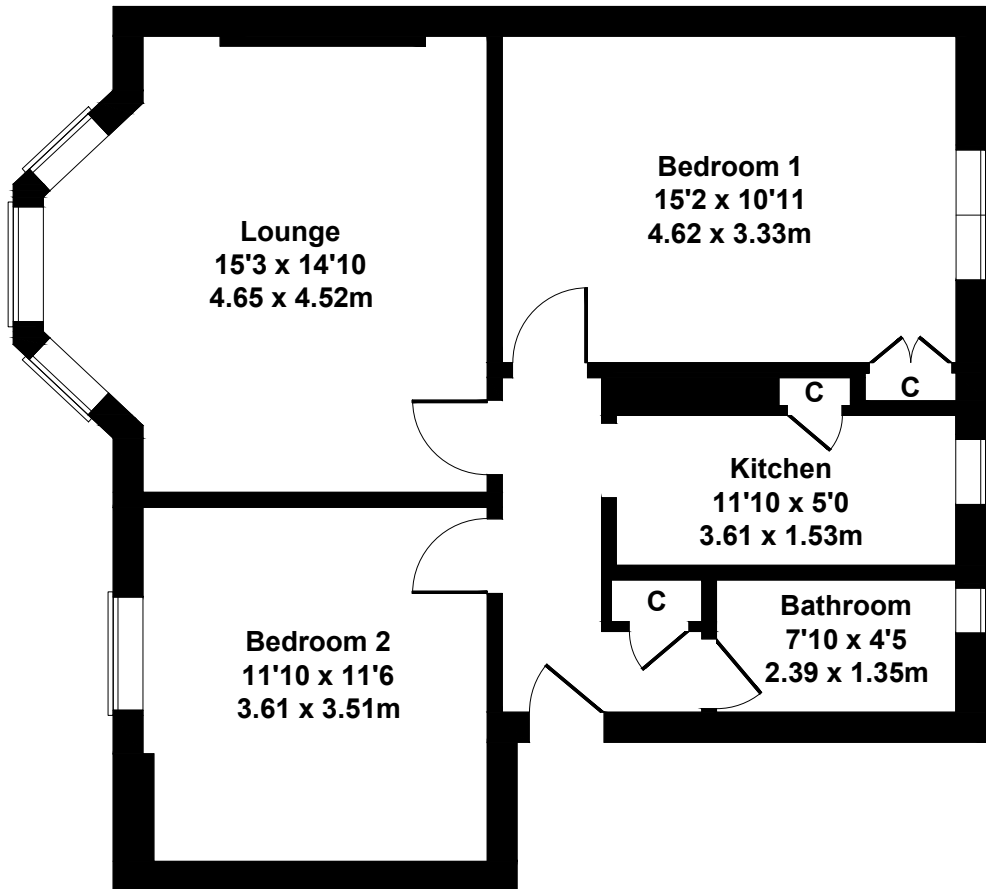

## SKETCH PLAN FOR ILLUSTRATIVE PURPOSES ONLY

All measurements walls, doors, windows, fittings and appliances, their sizes and locations, are approximate only. They cannot be regarded as being a representation by the seller, nor their agent.